

# VISION-3 LIGHTING

## MR16 Dual Sign Light **MODEL SL6** 12V 50W Max. ea., Dual MR16 Halogen 12V 7.5W ea., 12/24V 10W ea., or 12V 12.5W ea., Dual LED

### Specifications

#### Material

Machined 6061-T6 aluminum.

#### Head

Machined heads come in two styles: Side Mount and Rear Mount. (See illustration for aiming capabilities of each head.)

#### Stem

1" diameter machined stem comes in various stem lengths and three stem styles: Straight, 180° U-Bend, and 90° Gooseneck. (See illustration for calculating overall projection from wall for each stem style.)

#### Knuckle

A Rotate and Lock knuckle (protected under U.S. Patents #6,966,679, #7,108,405 and #7,458,552) mounts each head and allows for adjustability. Double taper design allows fixture to hold position during aiming and ensures a solid lock when tightened. Integral LED models have molded silicone wire seals to prevent water entry at knuckles.

#### Cap

Machined caps lock in place with one 18-8 stainless steel set screw, and are sealed to the body with a high temperature silicone O-ring. Regress Lens caps have drain holes for water drainage from top of lens if mounted in the up position. 'Flush Lens' cap styles incorporate a stepped lens to reduce the collection of water and debris on the lens. All caps accept up to three internal accessories, held in place by a stainless steel clip.

#### Mount Canopy

Available with the following mount options: MO3 (Machined Round Canopy), MO15 (Machined Square Canopy), and MO12 & MO13 (Surface Mount Powered Canopies). See mount specification sheets for more information. (Mount canopy must be mounted to an appropriate wall or junction box, in such a manner that is capable of holding the weight and torque created by the fixture. Junction box and hardware



US not included).

#### Finish

TGIC thermo set polyester powder coat paint available in 14 standard colors. Finish is applied over a corrosion resistant, hexavalent chromium free, RoHS compliant coating. Also available in one additional metal finish: Clear Anodized.

#### Lens

Tempered, clear lenses, secured to caps with a high temperature, UV curing, silicone adhesive.

#### Socket

Two GY-6.35 porcelain sockets with 600V, 250°C, PTFE coated 18 ga leads.

#### Lamps

**MR16 Halogen:** Two 12V bi-pin lamps up to 50W each.

**Integral LED:** Two 12-24V AC/DC 10W or two 12V AC/DC 12.5W LED modules, each includes integral driver with High/Low switch for 35W/20W (10W) or 50W/35W (12.5W) halogen equivalent outputs. LED Modules are field replaceable and feature replaceable lenses, an L70 > 60,000 hrs., dynamic transformer recognition, phase dimming (see Transformer and Dimmer Compatibility List), and patented LEDSense® thermal management.

**Retrofit MR16 LED:** Two 12V 7.5W bi-pin retrofit Soraa™ MR16 LED lamps with specially engineered heat sink mounts to ensure proper heat transfer to body. Note: Retrofit LED will overheat without supplied heat sink mount.

#### Certification

CSA tested & certified to US and Canadian safety standards for wet location wall mount use per UL1598 (Must be mounted in such a manner to properly support the fixture).

All ratings subject to change without notice. See web site or contact V3 for most current info.

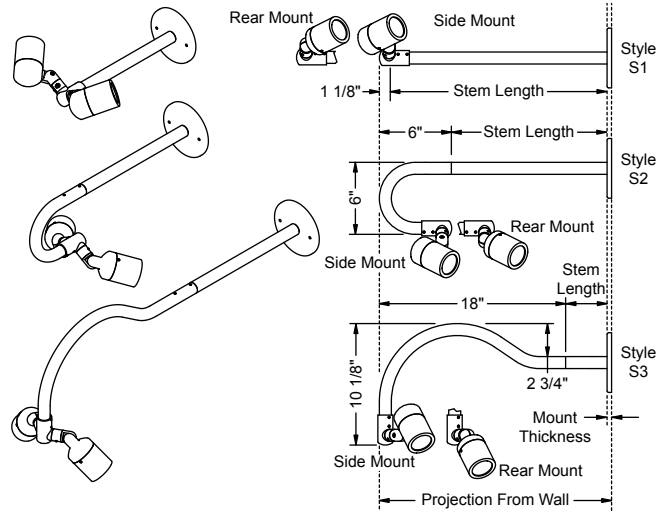

1 1/8" (for Style S1)  
6" (for Style S2)  
10 1/8" (for Style S3)

Projection From Wall = Stem Length + Mount Thickness + 6" (for Style S2)  
18" (for Style S3)

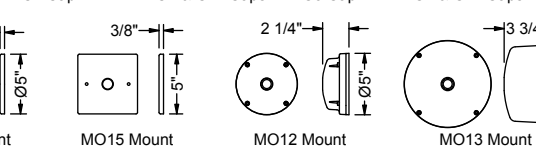
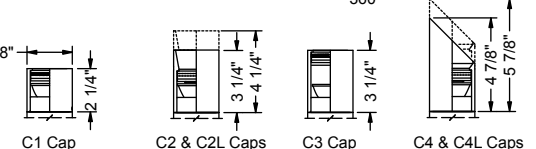
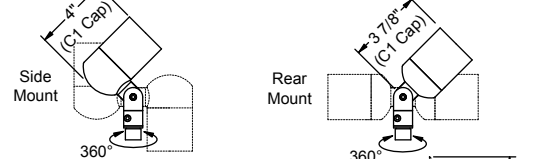

### Ordering Information

Model	Head	Stem	Mount	Lamp	Lens Accy	Filter	Louver
SL6A	SM - Side Mount RM - Rear Mount	6 - 6" Stem 12 - 12" Stem 18 - 18" Stem 24 - 24" Stem 30 - 30" Stem 36 - 36" Stem 42 - 42" Stem 48 - 48" Stem	MO3 - Round Canopy MO15 - Square Canopy MO12 - Surface Mount Canopy MO13 - Surface Mount Canopy	Integral LED (3000K, >80 CRI): <sup>3,4,5</sup> 116 - 10W, 12° 141 - 12.5W, 12° 117 - 10W, 21° 142 - 12.5W, 21° 118 - 10W, 41° 143 - 12.5W, 41° Retrofit MR16 LED (3000K, 95 CRI): <sup>4,5,6</sup> 147 - 7.5W, 10° 148 - 7.5W, 25° 149 - 7.5W, 36° MR16 Halogen: 0 - None 01 - ESX, 20W, 12° 02 - BAB, 20W, 40° 03 - FRB, 35W, 12° 05 - FMW, 35W, 40° 09 - EXT, 50W, 13° 10 - EXZ, 50W, 26° 11 - EXN, 50W, 40° 12 - FNV, 50W, 60° 04 - FRA, 35W, 23°	0 - None L1 - Spread L2 - Linear L3 - Softening	0 - None F4 - Green F5 - Amber F6 - Pink F7 - Mercury Vapor	0 - None H1 - Hex
<b>Finish</b>	<b>Cap Style</b>	<b>Style</b>	<b>Remote Transformer Required:</b>				
<b>Powder Coat Finishes:</b> BLT - Textured Black BNT - Textured Bronze BAT - Textured Bark GRT - Textured Green GNT - Textured Granite SAT - Textured Sand PAT - Textured Patina EAT - Textured Earth <b>Metal Finishes:</b> CLA - Clear Anodized	BL - Black BN - Bronze WI - White SI - Silver GY - Grey BE - Beige <b>Standard Lens:</b> C1 - Flush C2 - Regress Lens C2L - Regress Lens, Long C3 - Regress Lamp C4 - 45° Angled C4L - 45° Angled, Long <b>Flush Lens:</b> C1F - Flush C2F - Regress Lens C2LF - Regress Lens, Long C3F - Regress Lamp C4F - 45° Angled C4LF - 45° Angled, Long	S1 - Straight S2 - 180° U-Bend (available with 12" up to 42" stem option) S3 - 90° Gooseneck (available with up to 30" stem option)	MO3 - Round Canopy MO15 - Square Canopy MO12 - Surface Mount Canopy MO13 - Surface Mount Canopy <b>Integral Transformer:</b> <sup>5</sup> MO12-75-120 - MO12 w/ 75W, 120V MO12-75-230 - MO12 w/ 75W, 230V MO12-75-277 - MO12 w/ 75W, 277V MO13-75-120 - MO13 w/ 75W, 120V MO13-75-230 - MO13 w/ 75W, 230V MO13-75-277 - MO13 w/ 75W, 277V MO13-150-120 - MO13 w/ 150W, 120V MO13-150-277 - MO13 w/ 150W, 277V				

**Notes:**

- Other stem lengths are available upon request. Consult your Vision3 Lighting sales representative.
- See MO3, MO12, MO13, MO15 specification sheet for mount details.
- Only two lens accessories can be used with Integral LED.
- Other color temperatures & CRI's available as a special order.
- Only power LED options with V3 approved transformers. LED lamp options may not be compatible with 230V and 277V input. Contact V3 for compatibility info.
- Use only approved Retrofit MR16 LED lamps and supplied heat sink mount, otherwise LED may overheat.
- Specifications, certifications, and ordering information are subject to change. Please check website for latest specification sheets.

Example: SL6A - BN - SM - C1F - S1 - 18 - MO3 - 07 - L1 - 0 - 0